

cata 



E GLASS

ES LIBRO DE INSTRUCCIONES

FR MODE D'EMPLOI

EN INSTRUCTION MANUAL

NL HANDLEIDING

DE ANWEISUNGEN

IT ISTRUZIONI PER L'USO

PT INSTRUÇÕES DE USO

DA BRUGERVEJLEDNING

NO INSTRUKSJONER

SV BRUKSANVISNING

FI OHJEET

PL INSTRUKCJA OBSŁUGI

RU ИНСТРУКЦИИ

LT INSTRUKCIJOS

AR دليل التركيب

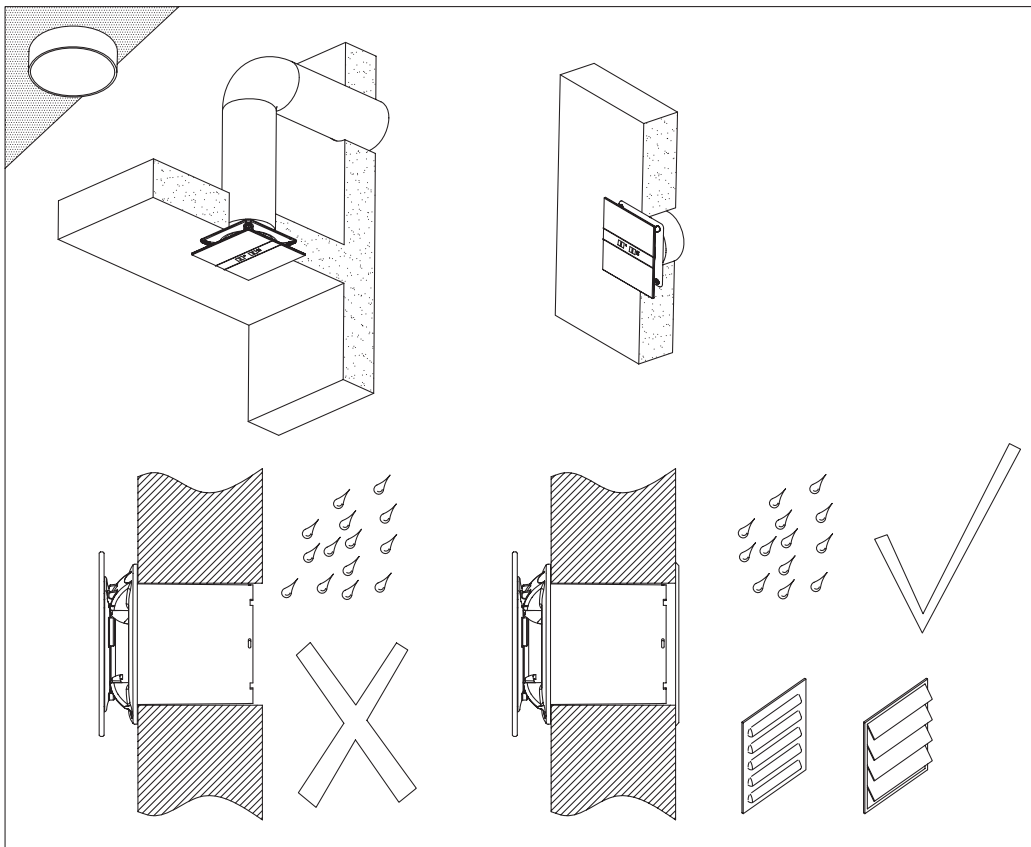

fig.1 A

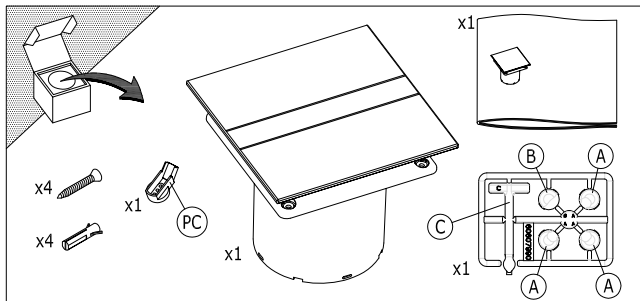

fig.1 B

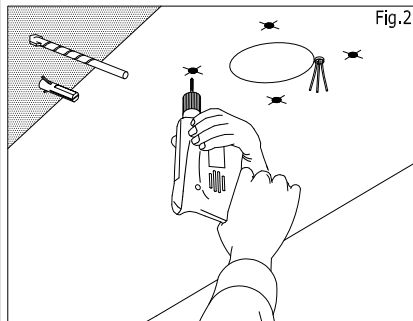
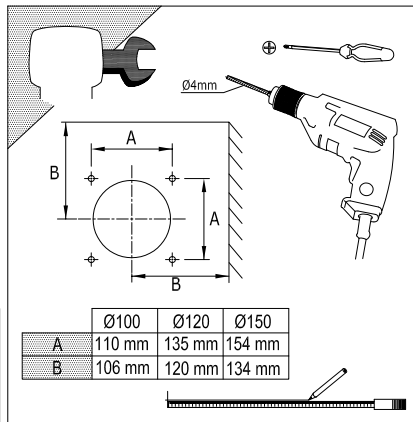
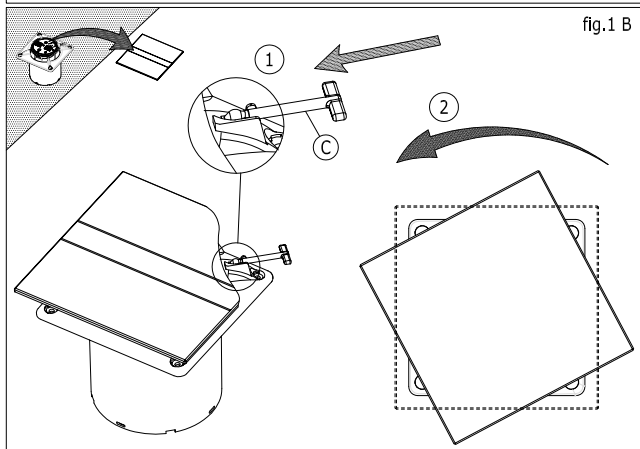

Fig.2

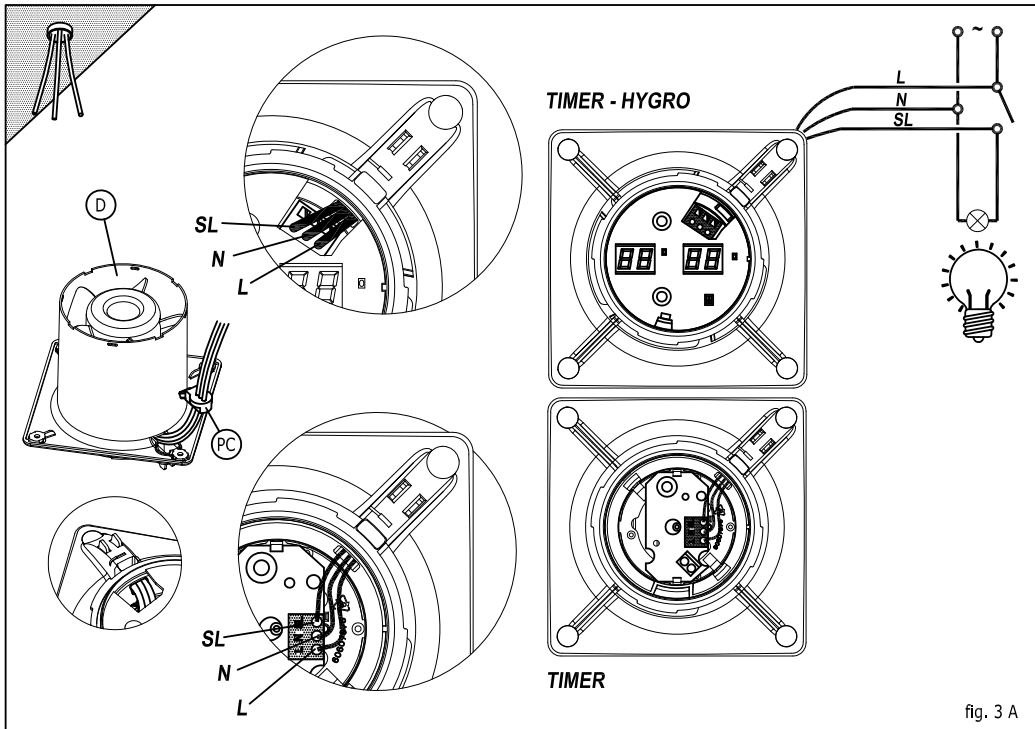
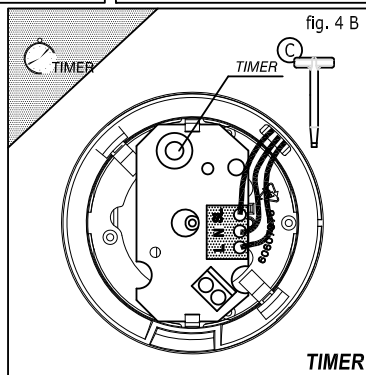
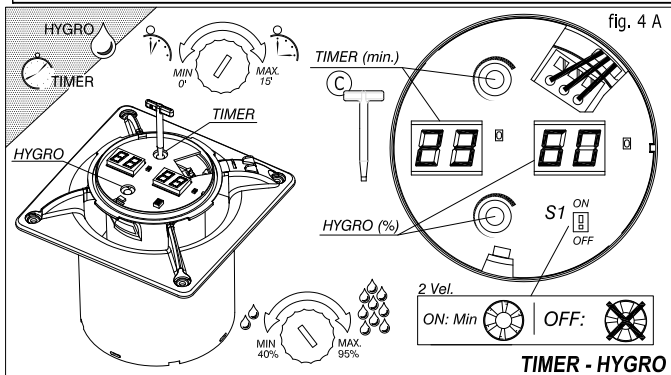
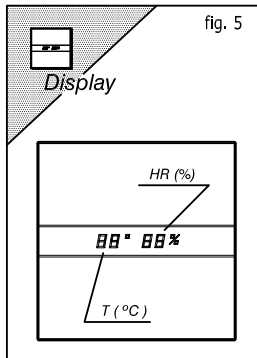
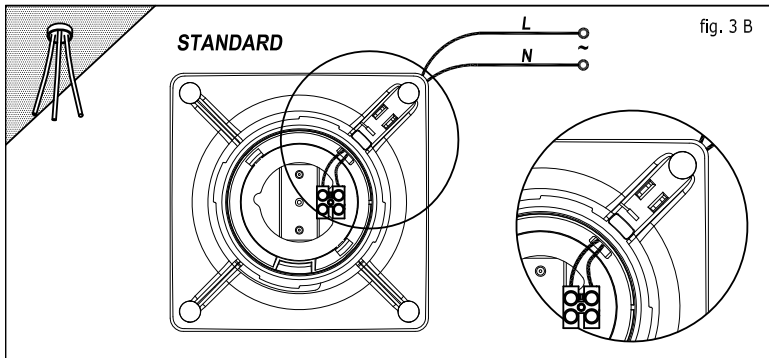
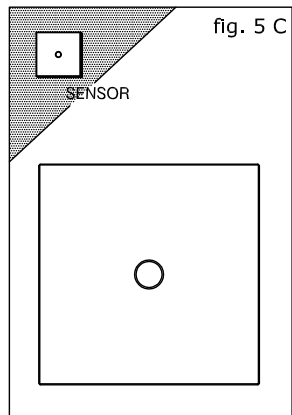
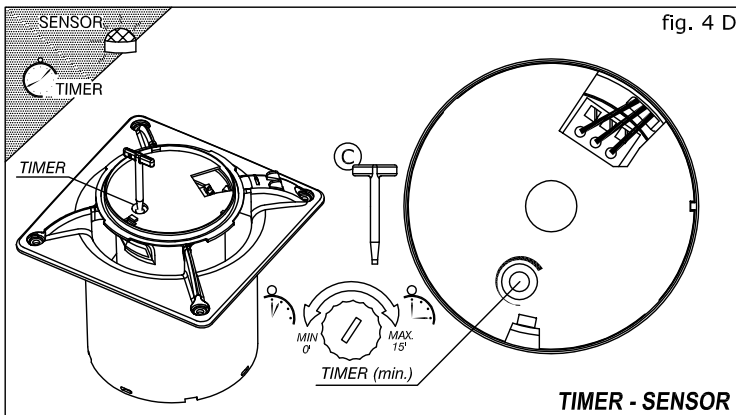
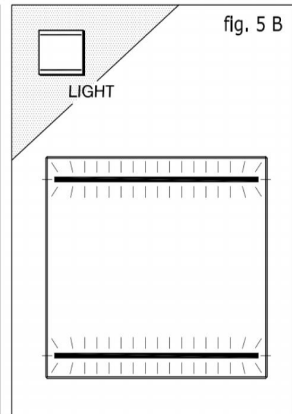
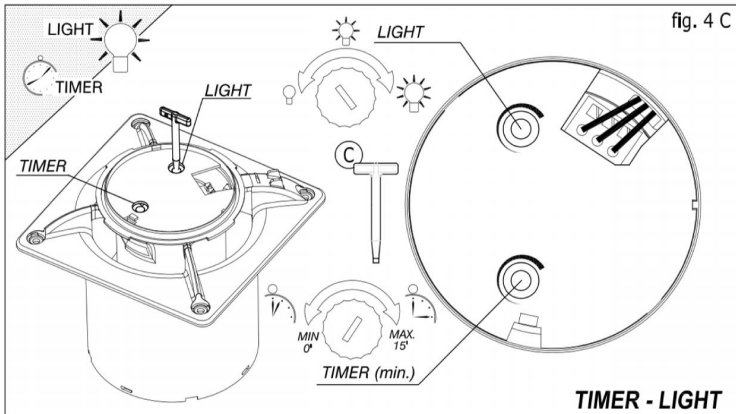
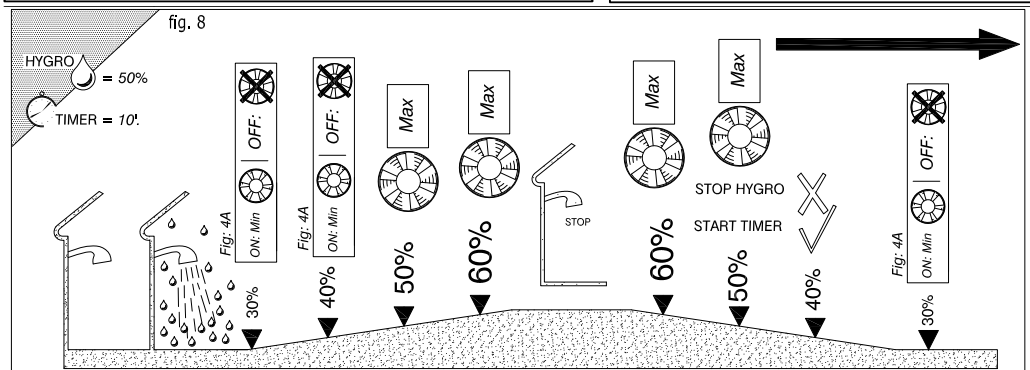
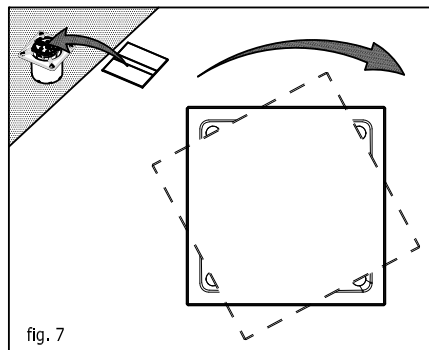
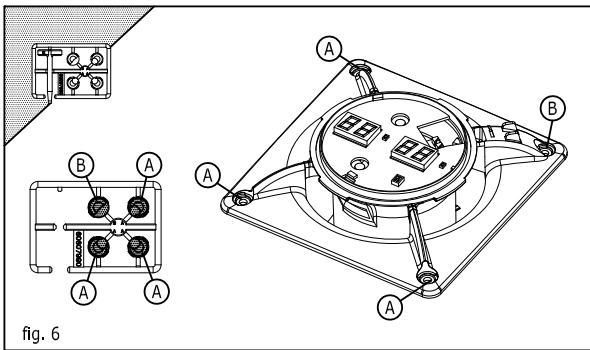

fig. 3 A







**Dear Customer,**

To guarantee the safety and correct working of the appliance, please read the following instructions **CAREFULLY** before beginning the installation.

**IMPORTANT:**

Make sure that the power supply has been disconnected before performing the installation or electrical connection of the appliance.

Installation, electrical connections and settings must be carried out by a qualified person in line with local regulations.

If these installation instructions are not followed the product may be damaged.

For optimal performance, the appliance must be installed correctly (installation of the unit, ducts and air replacement inlets).

This extractor fan is designed for the ventilation of households or similar premises. Do not use for any purpose other than that for which it was designed.

This appliance can be used by children aged from 8 years and above and persons with reduced physical, sensory or mental capabilities or lack of experience and knowledge if they have been given supervision or instruction concerning use of the appliance in a safe way and understand the hazards involved. Children shall not play with the appliance. Cleaning and user maintenance shall not be made by children without supervision.

The fan is to be installed so that the blades are more than 2,3 m above the floor.

"This extractor fan does not produce radio/television interference (Directive 2004/108/EC).



Prior to piping installation, consult the municipal by-laws on air outlets and request permission from the person responsible for the building.

Precaution must be taken to avoid the backflow of gases into the room from the open gas pipe or from other open-flame devices.

The room must have adequate ventilation if this appliance is used simultaneously with other appliances that run on gas or other fuels.

Do not install the exhaust conduit (D) of the extractor fan to a chimney flume, ventilation pipes, hot air ducts or ducts used to evacuate fumes from appliances that run on gas or other fuels.



DO NOT install this product in areas with the following characteristics:

- Excess of oil or grease.
- Areas with corrosive or flammable liquid gas or vapour.
- Areas with temperatures higher than 40 °C or lower than -5 °C.
- Areas exposed to the environment (rain, sun, snow, etc.)
- Areas with possible obstacles that obstruct the access to the fan.

The product and its parts must not be submerged in water or other liquids.

The IP rating is only valid if the installation of the appliance complies with what is indicated in this manual.

The manufacturer declines all responsibility for personal injury or damage to animals or objects caused by inappropriate use of the appliance according to the warnings for installation, use and

maintenance described in this instruction manual. After finishing the installation these instructions should be given to the owner/user of the appliance. The appliance must be able to be disconnected from the mains electricity supply after installation. It can be disconnected by making the plug accessible or by incorporating a switch in the fixed wiring that meets electrical installation standards.



INSTALLATION:

Before starting the installation, check that the propeller is not deformed or damaged, that it can turn freely, and that no foreign body is lodged inside the outer casing."

The appliance shall be installed according to the attached graphic documentation. It may be installed on the wall or ceiling, with direct exhaust to an individual exhaust duct (see fig. 1A)

To install, make a circular hole with a diameter corresponding to the model (100 mm, 120 mm, or 150 mm) in the wall or ceiling where the appliance will be installed, together with the holes for fixing it (See Fig 2).

Remove the cover as shown in fig. 1B

Run the power supply cables through the "PC" part and the conduit in the appliance (see fig. 3A). Connect according to section "ELECTRICAL CONNECTION"

If the assembly is done with an individual exhaust tube, place the tube (D) in the hole prepared for air exhaust.

Whether the assembly is done with an individual exhaust tube or with a direct outlet, air grilles must be installed that comply with national safety requirements for preventing access to the fan blades (see fig. 1A)

Make sure that there is no obstacle blocking the flow of air.

Attach the base of the casing using the plugs and screws supplied by the manufacturer.



ELECTRICAL CONNECTION:

Make sure that the voltage (V) and frequency (Hz) of the power supply correspond to the values indicated on the nameplate.



The appliance must be permanently connected with fixed installation wiring, fitted in the wall and entering the appliance through the rear side.

(Cable rigid or stiff-tipped 2 or 3 wires, with a minimum cross-section of 1 mm² and maximum of 1.5 mm²).

No earthing connection is required, given that this is a doubly-insulated appliance. (Class II).

The power supply cable must be placed so that no liquid or vapour can enter the

appliance along it. If this were not possible, the cable entry should be sealed additionally, e.g. with silicone. Otherwise, the indicated IP rating would not be maintained.



Available versions:

STANDARD: STANDARD fan. Does not require setting

TIMER: Fan with TIMER control. Adjustable timer from 3' to 15'.

TIMER-HYGR0: Fan with TIMER-HYGR0 control. Activation by humidity control between 40% and 95%. Adjustable timer from 0' to 15'.

Designed for continuous general ventilation of humid rooms (bathrooms, kitchens, washing rooms and toilets).

E 100 GST: Fan equipped with Timer and Presence Sensor. Timer adjustable between 0' and 15'. Presence detection range of up to 3-4 m.

E 100 GTL: Fan equipped with Timer and Ambient Light. Timer adjustable between 0' and 15'. Light adjustment between off and maximum intensity.

For the electrical connection, follow the connection diagram according to the model that is to be connected (see fig. 3A-3B).

In the event that this appliance is not used, it is recommended that you disconnect it from the mains electricity supply.

"



SETTINGS AND OPERATION:

Perform the necessary settings according to the model installed.

TIMER (see fig. 4B)

To set the timer, turn the "TIMER" pin clockwise to increase the time (3' - 15').

The extractor fan will start, activated by the switch. When the switch is deactivated, the fan continues working for the set time and then turns off.

TIMER-HYGR0 (see fig. 4A)

When power is applied for the first time, the fan goes into test mode for a few seconds, and during that time the displays show the factory-set Timer - Hygro values.

To adjust the timer, turn the "TIMER" pin until the desired value appears on the display (0' - 15').

To adjust the level of humidity, turn the "HYGR0" pin until the desired value appears on the display (40% - 95%).

The **GTH** model permits the continuous ventilation (for 24 hours) of damp rooms through the ACTIVATION of S1 switch (S1: ON).

When the level of humidity is higher than the set level, the Hygro function is activated and the fan will operate at maximum speed.

Once the level of humidity falls below the set value, the device will continue to operate at maximum speed for the period of time set in the Timer function, and will eventually stop if S1=OFF or continue to operate at low speed if S1=ON.

Maximum and slow speeds are factory settings.

The extractor fan will also start, at maximum speed, if activated by the light switch in

the room. When the light switch in the room is turned off, the fan will continue to work at maximum speed for the period of time set in the Timer function, and will eventually stop if S1=OFF or continue to operate at low speed if S1=ON.

PIR SENSOR (see figure 4D)

To regulate the timer, rotate the "TIMER" control knob clockwise to increase the time setting (0' - 15').

When the extractor connects to the mains, the presence sensor is precharged for one minute. The extractor then remains on stand-by ready for normal operation.

The extractor starts up when the Presence Detector is activated. If the sensor does not detect any movement, the extractor will remain in operation for the length of time selected in the Timer setting and will eventually stop, returning to stand-by.

LIGHT (see figure 4C)

Fan equipped with Timer and Ambient Light. Timer adjustable between 0' and 15'. Adjustment of light intensity between off and maximum intensity.

To regulate the timer, rotate the "TIMER" control knob clockwise to increase the time setting (0' - 15').

To adjust the brightness of the LED lights, rotate the LIGHT knob in a clockwise direction to increase the light intensity (0 – MAX).

The extractor is activated with the switch, and the LED lights come on at MAXIMUM intensity. When the switch is turned off, the fan continues to operate for the set time and the LED lights are replaced by the selected form of lighting. Finally the fan switches off fully and the level of lighting remains at the set intensity.



To finish the installation, verify that all the connections have been done correctly and make sure that the cables are placed correctly.

Install the front cover in its position and make sure that it cannot be removed without using a tool (see fig. 7).

Make sure that the blades turn freely.

Cleaning and Maintenance:

- Before cleaning make sure that the appliance is not connected to the electric network and prevent it from being reconnected by accident.
- Clean with a damp cloth regularly.
- The appliance does not require additional maintenance. Always demand original spare parts for repairs.
- The motor, propeller and all components should be inspected periodically to ensure that they are not dirty and have not suffered any damage. The frequency of inspections depends on the appliance's operating conditions.
- Remove the dirt on the propeller and the inner parts of the casing to avoid imbalances during operation, a decrease in aerodynamic performance and motor damage.

This device is not a precision thermometer / hygrometer.

The displayed values of T° and HR are only for reference

THE MANUFACTURER reserves the right to make any technological improvement or modification without prior notification.



CATA ELECTRODOMÉSTICOS S.L. guarantees that this product will fulfill the use for which it was designed for a period of two (2) years.

This guarantee includes both materials and labour. Due to its small size and ease of transport, the product must be taken by the user to the nearest Official Technical Service Department of CATA.

To repair the product, it should be taken by the consumer to the brand's official technical assistance service department; and to replace the product, cancel the sale or obtain a reduction in the price, where appropriate, it should be taken to the point of sale. The product must be presented with its invoice or purchase ticket, or delivery note if later.

If a fault is detected, the consumer is entitled to demand the repair or replacement of the product, unless either of these options is impossible or disproportionate, within a reasonable period of time. If repairing or replacing the product is impossible or inappropriate, the consumer may choose to receive a discount on the price of the product or to cancel the purchase and receive a full refund.

This guarantee will not be applicable in the event of the improper use or misuse of the product, its improper handling by unauthorised persons, or the consumer's failure to clean or maintain the product on a periodic basis (cleaning of filters, replacement of bulbs). Please keep in mind that glass is not covered by the guarantee if it is broken as the result of improper use. This product has been designed solely and exclusively for domestic use; hence, this guarantee does not cover professional use or the use of the product in any unforeseen way.

The right to demand the fulfilment of the provisions of this guarantee will lapse after three years from the delivery of the product, and the consumer is required to provide notice of any fault within two months of becoming aware of it.

This guarantee does not affect the consumer's rights under the provisions of Law 23/2003, of 10 July, on Guarantees in the Sale of Consumer Goods.



The symbol on the product or on its packaging indicates that this product may not be treated as household waste. Instead it shall be handed over to the applicable collection point for the recycling of electrical and electronic equipment. By ensuring this product is disposed of correctly, you will help prevent potential negative consequences for the environment and human health, which could otherwise be caused by inappropriate waste handling of this product. For more detailed information about recycling of this product, please contact your local city office, your household waste disposal service or the shop where you purchased the product.



CNA
group

CATA ELECTRODOMÉSTICOS, S.L.

Oficinas: c/ Anabel Segura, 11, Edif. A, 3a pl. 28108. Alcobendas. Madrid. España

Fábrica: c/ del Ter 2, Apdo. 9. 08570. Torelló. Barcelona. España

T. +34 938 594 100 - Fax +34 938 594 101

www.cnagroup.es - cna@cnagroup.es

Atención al Cliente: 902 410 450 / +34 938 521 818 - info@cnagroup.es

SAT Central Portugal: +351 214 349 771 - service@junis.pt